

**BEAUTIFICATION OF  
DURGIANA MANDIR COMPLEX  
AMRITSAR  
(PROPOSED PARKING )**

**GENERAL NOTES:**

1. The contractor/site engineer is to verify and relate all dimensions on site before execution of work. Change, if any is brought to the notice of architect immediately.
2. All dimension are to be read and not to be scaled.
3. All architectural and other drawings must be co-related by the contractor before execution of work.
4. Entire construction work is to be executed as per P.W.D. Specifications, B.I.S. Specifications and Specifications of each item as per approved in the Detail Estimate.

**OWNER :**

**ARCHITECT :**

VIVEK SUD  
(BARCHM.CA.AJIA)

**DRAWING TITLE**

**BASEMENT WATER PROOFING DETAIL**



DRAWING NO. DET - 06 a	DRAWN BY SEEMA
PROJ.NO. 0967	CHKD. BY SHARDA PAL
SCALE. 1/2" - 1'-0"	DATE 21.02.2013

**ARCHITECTS CONSORTIUM**

ARCHITECTS, PLANNERS, ENGINEERS,  
INTERIOR & INDUSTRIAL DESIGNERS  
S.C.O - 42, PHASE-3B2, MOHALI. (Pb.).  
☎ - 0172-5093132; ☎ - 0172-4643132;  
📞 - 98154 43132.  
E-mail - info@sudvivek.com  
Web site :- www.sudvivek.com

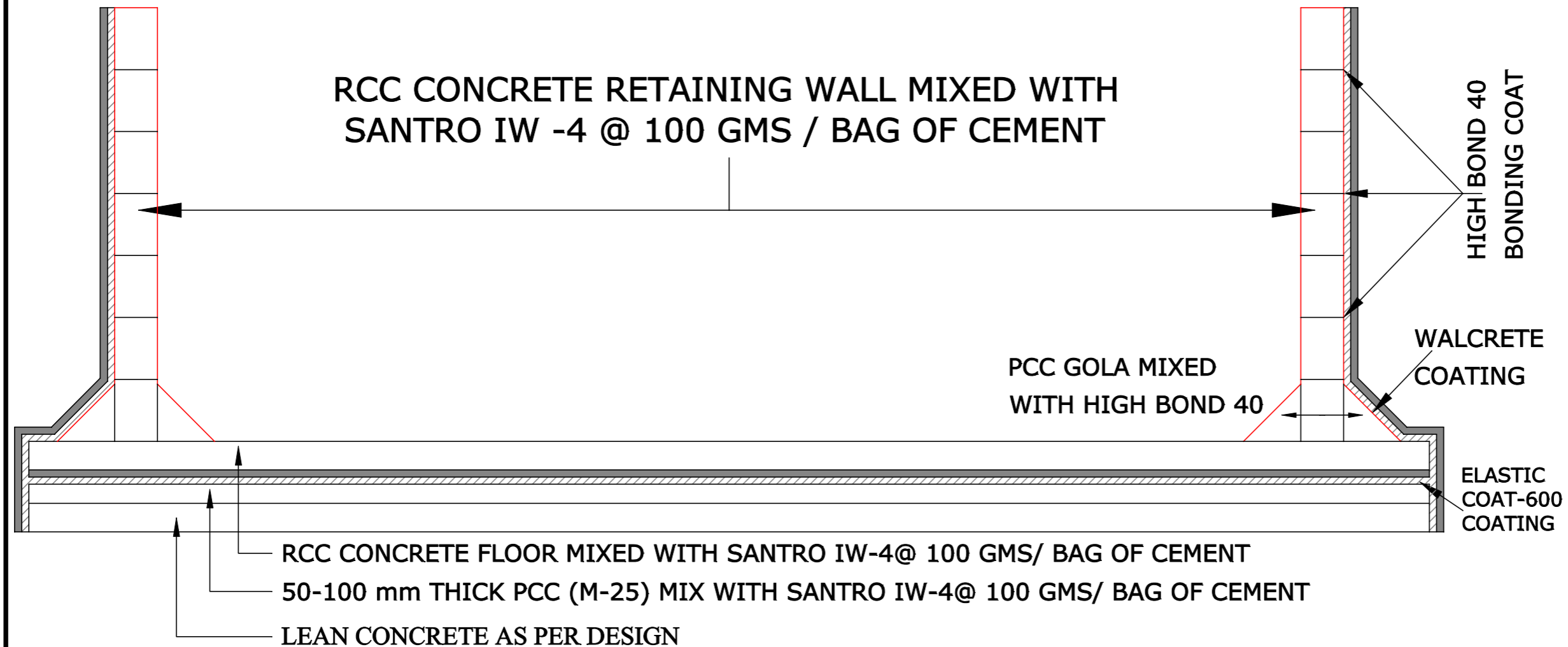
COPYRIGHT



-  CEMENT PLASTER MIXED WITH STANRO IW - 4 @ 100 GMS/ BAG OF CEMENT
-  WATERPROOF COATING WITH ELASTIC COAT-600 SANDWITCHED WITH SPL. SYNTHETIC FIBRE MESH
-  FOR RETAINING WALL APPLY TWO COATS OF WALCRETE COATING

**Note:-**

1. Entire construction work is to be executed as per P.W.D. Specifications , B.I.S. Specifications and Specifications of each item as per approved in the Detail Estimate.
2. Basement Concreting , Water Proofing Treatment & Treatment to construction joints should be properly followed as per Specifications given in the Detail Estimate.