

BEAUTIFICATION OF DURGIANA MANDIR COMPLEX AMRITSAR (PROPOSED PARKING)

GENERAL NOTES:

1. The contractor/site engineer is to verify and relate all dimensions on site before execution of work. Change, if any is brought to the notice of architect immediately.
2. All dimension are to be read and not to be scaled.
3. All architectural and other drawings must be co-related by the contractor before execution of work.
4. Entire construction work is to be executed as per P.W.D. Specifications, B.I.S. Specifications and Specifications of each item as per approved in the Detail Estimate.

OWNER :

ARCHITECT :

VIVEK SUD
(B.ARCH,M.CA.,A.I.I.A.)

DRAWING TITLE

SECTIONS AT G-G	
DRAWING NO.	DRAWN BY
A-07 b	SEEMA
PROJ.NO.	CHKD. BY
0967	SHARDA PAL
SCALE.	DATE
	22.06.2013

ARCHITECTS CONSORTIUM

ARCHITECTS, PLANNERS, ENGINEERS,
INTERIOR & INDUSTRIAL DESIGNERS
S.C.O - 42, PHASE-3B2, MOHALI. (Pb.).
☎ - 0172-5093132; ☎ - 0172-4643132;
☎ - 98154 43132.
E-mail - info@sudvivek.com
Web site :- www.sudvivek.com
COPYRIGHT

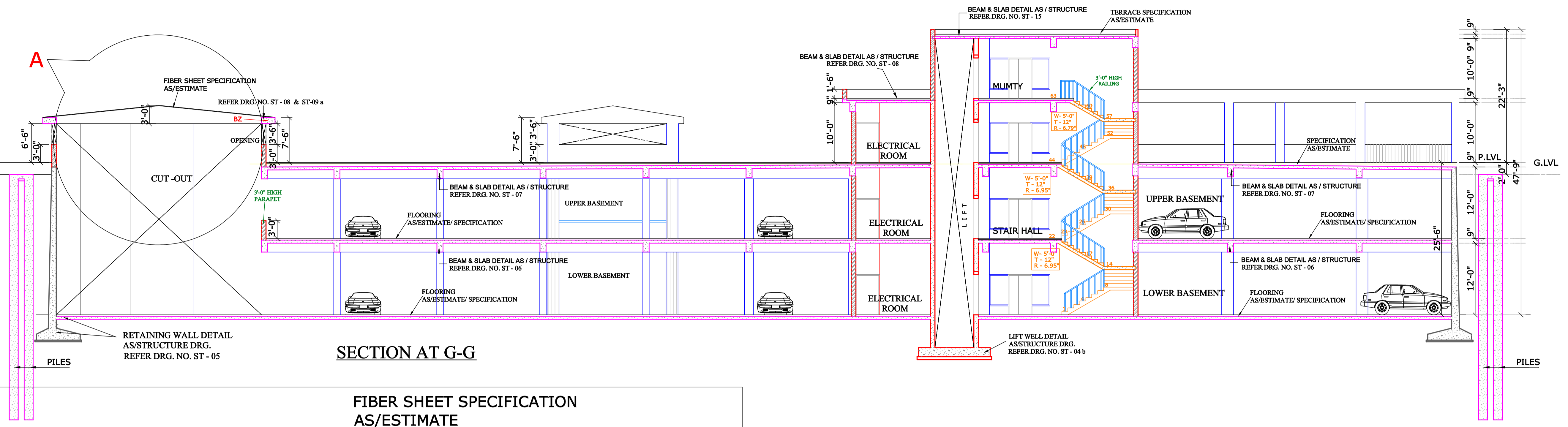

SECTION AT G-G

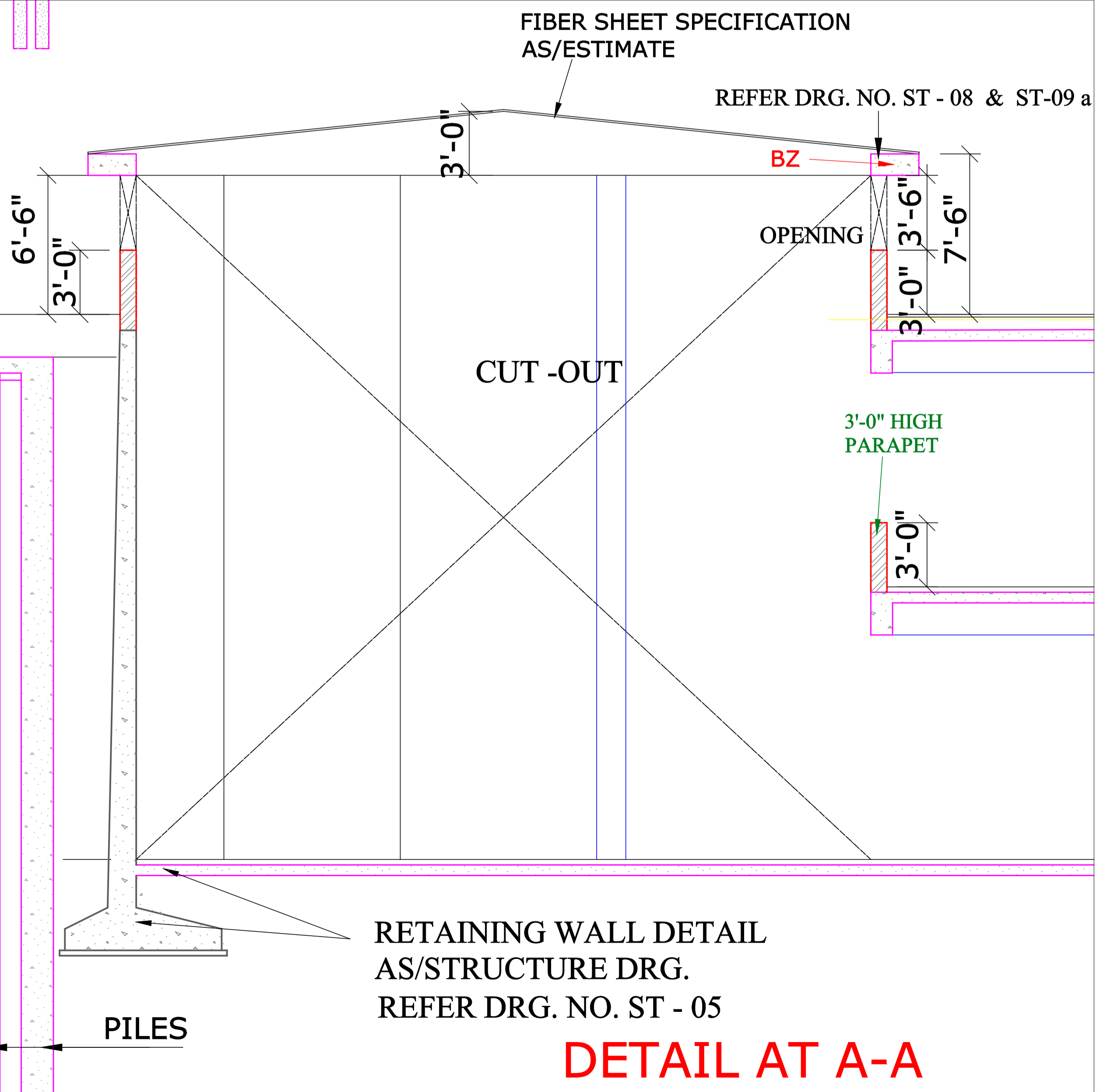

DETAIL AT A-A

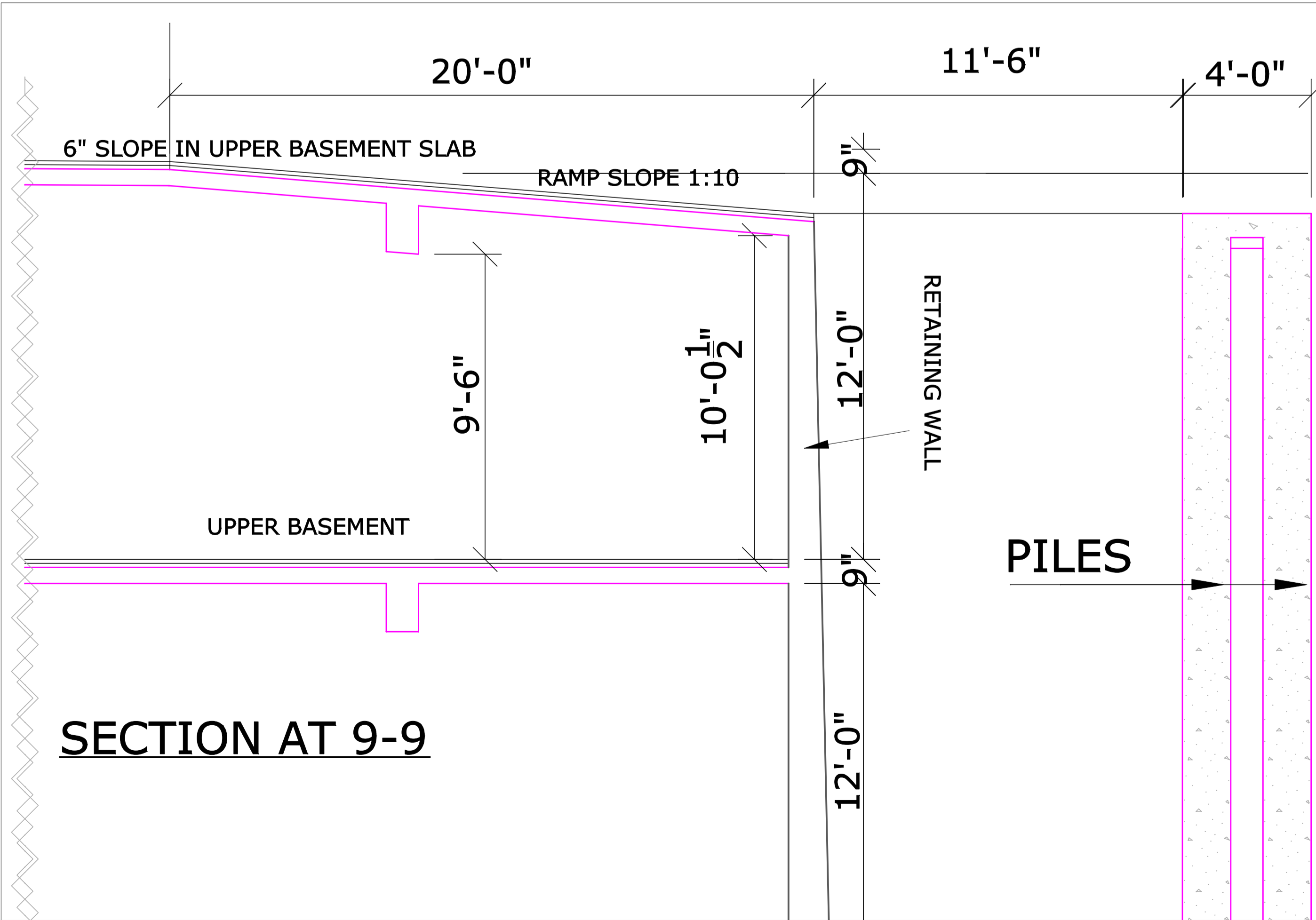

SECTION AT 9-9

- Note:-**
1. Entire construction work is to be executed as per P.W.D. Specifications, B.I.S. Specifications and Specifications of each item as per approved in the Detail Estimate.
 2. Basement Concreting, Water Proofing Treatment & Treatment to construction joints should be properly followed as per Specifications given in the Detail Estimate.