

**BEAUTIFICATION OF  
DURGIANA MANDIR COMPLEX  
AMRITSAR  
(PROPOSED PARKING )**

**SCHEDULE OF DOORS & WINDOWS**

SR. NO.	TYPE	NOS.	MASONRY OPENING			
			WIDTH	HEIGHT	CILL	TOP
1	D		4'-0"	6'-9"	---	6'-9"
2						
3	W		4'-0"	3'-9"	3'-0"	6'-9"
4	W1		3'-3"	5'-3"	1'-6"	6'-9"
5	W2		3'-0"	5'-3"	1'-6"	6'-9"
6						
7						

- GENERAL NOTES:**
- The contractor/site engineer is to verify and relate all dimensions on site before execution of work. Change, if any is brought to the notice of architect immediately.
  - All dimension are to be read and not to be scaled.
  - All architectural and other drawings must be co-related by the contractor before execution of work.
  - Entire construction work is to be executed as per P.W.D. Specifications , B.I.S. Specifications and Specifications of each item as per approved in the Detail Estimate.

**OWNER :**

**ARCHITECT :**

VIVEK SUD  
(B.ARCH.,C.A.,A.I.I.A.)

**DRAWING TITLE**

**GROUND FLOOR PLAN**

DRAWING NO.	DRAWN BY
A-06	SEEMA
PROJ.NO.	CHKD. BY
0967	SHARDA PAL
SCALE.	DATE
1/16" - 1'-0"	08.01.2013

**ARCHITECTS CONSORTIUM**

ARCHITECTS, PLANNERS, ENGINEERS,  
INTERIOR & INDUSTRIAL DESIGNERS  
S.C.O - 42, PHASE-3B2, MOHALI. (Pb.)  
☎ - 0172-5093132; ☎ - 0172-4643132;  
☎ - 98154 43132.  
E-mail - info@sudvivek.com  
Web site :- www.sudvivek.com  
COPYRIGHT

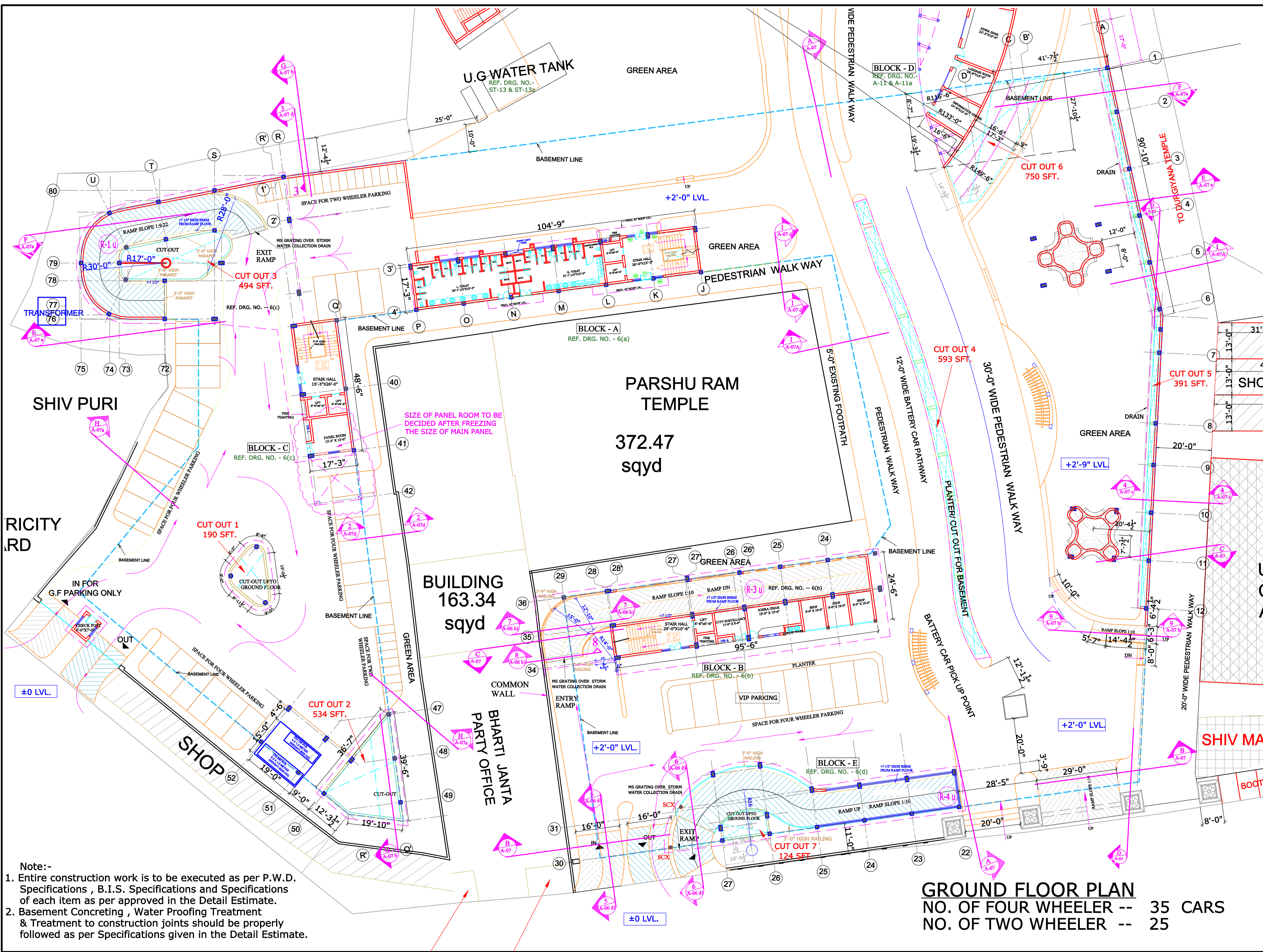

- Note:-**
- Entire construction work is to be executed as per P.W.D. Specifications , B.I.S. Specifications and Specifications of each item as per approved in the Detail Estimate.
  - Basement Concreting , Water Proofing Treatment & Treatment to construction joints should be properly followed as per Specifications given in the Detail Estimate.

**GROUND FLOOR PLAN**  
NO. OF FOUR WHEELER -- 35 CARS  
NO. OF TWO WHEELER -- 25