

BEAUTIFICATION OF DURGIANA MANDIR COMPLEX AMRITSAR (PROPOSED PARKING)

- GENERAL NOTES:
1. The contractor/site engineer is to verify and relate all dimensions on site before execution of work. Change, if any is brought to the notice of architect immediately.
 2. All dimension are to be read and not to be scaled.
 3. All architectural and other drawings must be co-related by the contractor before execution of work.
 4. Entire construction work is to be executed as per P.W.D. Specifications, B.I.S. Specifications and Specifications of each item as per approved in the Detail Estimate.

OWNER :

ARCHITECT :

VIVEK SUD
(B.A.R.C.H.M.C.A.-A.I.I.A.)

DRAWING TITLE		TOILET DETAIL BLOCK - A	
DRAWING NO.	A 06 a2	DRAWN BY	SEEMA
PROJNO. :-	0967	CHKD. BY	SHARDA PAL
SCALE:		DATE	20.04.2013

ARCHITECTS CONSORTIUM

ARCHITECTS, PLANNERS, ENGINEERS, INTERIOR & INDUSTRIAL DESIGNERS
S.C.O - 42, PHASE-3B2, MOHALI. (Pb.).
☎ - 0172-5093132; 4643132;
☎ - 98154 43132.
E-mail - info@sudvivek.com
Web site :- www.sudvivek.com

© COPYRIGHT

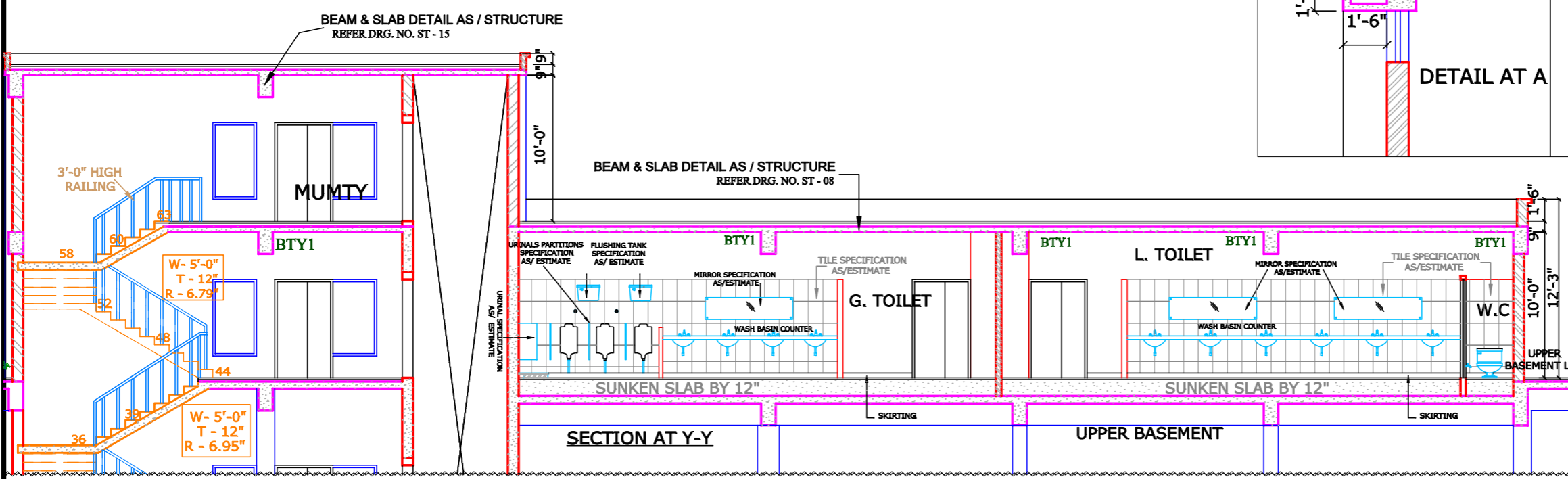
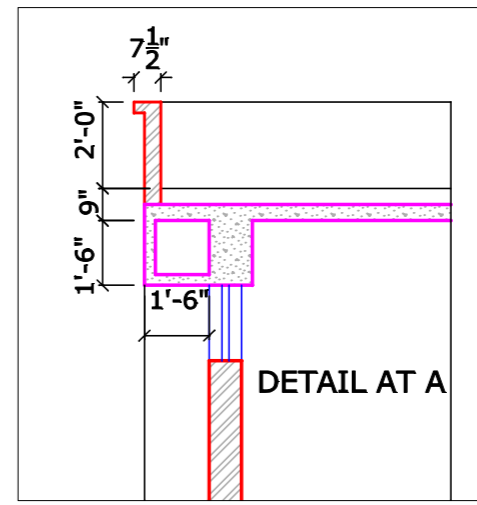

- Note:-
1. Entire construction work is to be executed as per P.W.D. Specifications, B.I.S. Specifications and Specifications of each item as per approved in the Detail Estimate.
 2. Basement Concreting, Water Proofing Treatment & Treatment to construction joints should be properly followed as per Specifications given in the Detail Estimate.

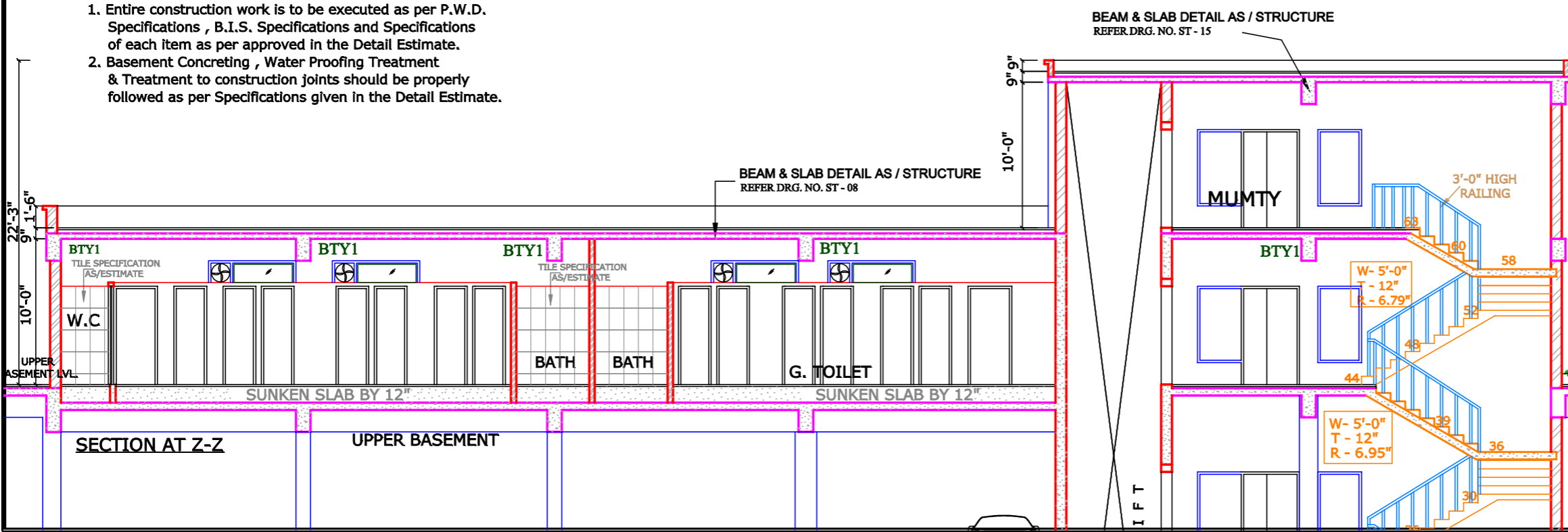

REF. DRG. NO. A06, A06 a & A06 a1