

*Indian Standard*

**COMMERCIAL ROAD VEHICLES —  
CONNECTIONS FOR REAR-MOUNTED  
POWER TAKE-OFFS ( PTO )**

UDC 629·11·013 : 629·114·4 - 494 : 006·78

© BIS 1990

**BUREAU OF INDIAN STANDARDS**  
MANAK BHAVAN, 9 BAHADUR SHAH ZAFAR MARG  
NEW DELHI 110002

*Indian Standard*

**COMMERCIAL ROAD VEHICLES —  
CONNECTIONS FOR REAR-MOUNTED  
POWER TAKE-OFFS ( PTO )**

**NATIONAL FOREWORD**

This standard which is identical with ISO 7707: 1986 'Commercial road vehicles — Connections for rear-mounted power take-offs (PTO)' was adopted by the Bureau of Indian Standards on 17 March 1990, after the draft finalized by the Automotive Transmission Systems Sectional Committee (TED 3) had been approved by the Transport Engineering Division Council.

The text of ISO standard has been approved as suitable for publication as Indian Standard without deviations. Certain conventions are, however, not identical to those used in Indian Standards. Attention is particularly drawn to the following:

- a) Wherever the words 'International Standard' appear, referring to this standard, they should be read as 'Indian Standard'.
- b) Comma (,) has been used as a decimal marker while in Indian Standards, the current practice is to use point (.) as the decimal marker.

**CROSS REFERENCES**

In this Indian Standard, the following International Standard is referred to. Read in its place the following:

<i>International Standard</i>	<i>Corresponding Indian Standard</i>	<i>Degree of Correspondence</i>
ISO 7706 : 1986 Road vehicles — Commercial vehicles — Clearance envelope for power take-offs (PTO)	IS 12971 : 1990 Road vehicles — Commercial vehicles — Clearance envelope for power take-offs (PTO)	Identical

As in the Original Standard, this Page is Intentionally Left Blank

## **1 Scope and field of application**

This International Standard specifies the essential dimensions of connections for rear-mounted power take-offs (PTO). These specifications are applicable to all installations of power take-offs at the back of transmission gearboxes of commercial vehicles.

## **2 Reference**

ISO 7706, *Road vehicles – Commercial vehicles – Clearance envelope for power take-offs (PTO)*.

## **3 Specifications**

This International Standard defines three connection types for rear-mounted PTOs :

- Type A
- Type B
- Type E

Type A is, however, recommended if the design of the transmission permits. Type E may be used for stepped PTOs.

## **4 Designation**

Example for the designation of a type A connection for a rear-mounted PTO :

**PTO rear connection ISO 7707-A**

Connections for rear-mounted PTO

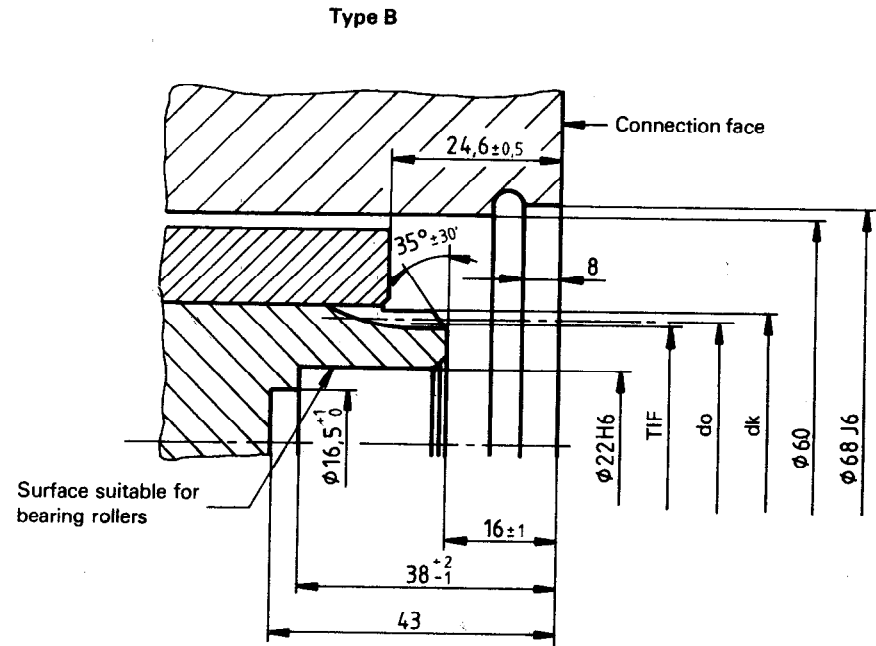
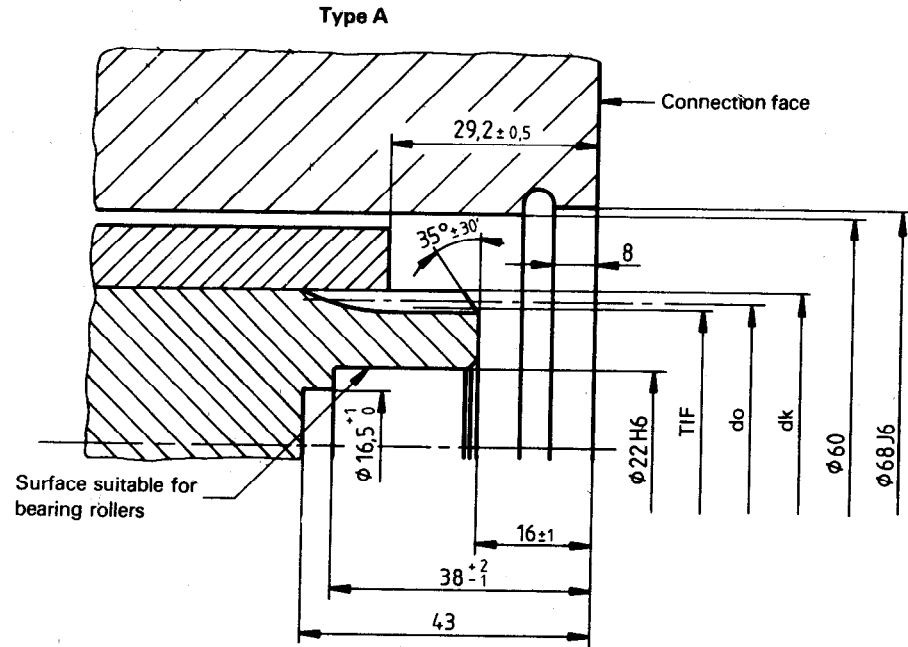

Spline data

No. of teeth :	12
Standard module :	3,25
Pressure angle :	20°
TIP diameter :	44,4 h11
Reference diameter :	39,0
Form diameter :	38,85
Span over two teeth :	16,21
	16,16

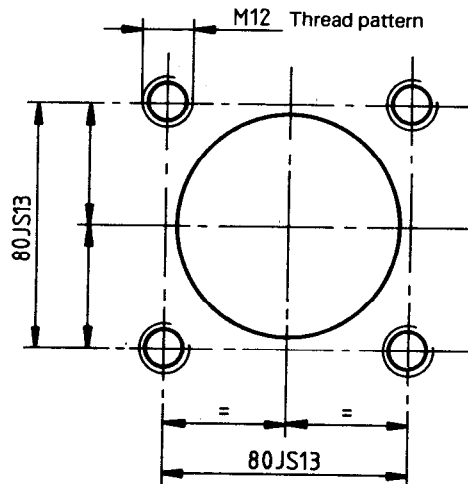

Spline data

No. of teeth :	12
Standard module :	3,0
Pressure angle :	20°
TIP diameter :	39,9 h11
Reference diameter :	36,0
Form diameter :	35,35
Span over two teeth :	13,98
	13,92

NOTE — The length of bolts is specified by the manufacturer.

## Bureau of Indian Standards

BIS is a statutory institution established under the *Bureau of Indian Standard Act, 1986* to promote harmonious development of the activities of standardization, marking and quality certification of goods and attending to connected matters in the country.

### Copyright

BIS has the copyright of all its publications. No part of these publications may be reproduced in any form without the prior permission in writing of BIS. This does not preclude the free use, in the course of implementing the standard, of necessary details, such as symbols and sizes, type of grade designations. Enquiries relating to copyright be addressed to the Director (Publications), BIS.

### Revision of Indian Standards

Indian Standards are reviewed periodically and revised, when necessary and amendments, if any, are issued from time to time. Users of Indian Standards should ascertain that they are in possession of the latest amendments or edition. Comments on this Indian Standard may be sent in BIS giving the following reference :

Doc : No. TED 3 ( 5242 )

#### Amendments Issued Since Publication

Amend No.	Date of Issue	Text Affected

## BUREAU OF INDIAN STANDARDS

### Headquarters :

Manak Bhavan, 9 Bahadur Shah Zafar Marg, New Delhi 110002  
Telephone : 331 01 31, 331 13 75

Telegrams : Manaksanstha  
(Common to all Offices)

### Regional Offices :

	Telephone
Central : Manak Bhavan, 9 Bahadur Shah Zafar Marg NEW DELHI 110001	{ 331 01 31 331 13 75
Eastern : I/14, C.I.T. Scheme VII M, V.I.P. Road, Maniktola, CALCUTTA 700054	37 86 62
Northern : SCO 445-446, Sector 35-C, CHANDIGARH 160036	2 18 43
Southern : C.I.T. Campus, IV Cross Road, MADRAS 600113	41 29 16
Western : Manakalaya, E9 MIDC, Marol, Andheri ( East ) BOMBAY 400093	6 32 92 95

Branches : AHMADABAD. BANGALORE. BHOPAL. BHUBANESHWAR. COIMBATORE.  
FARIDABAD. GHAZIABAD. GUWAHATI. HYDERABAD. JAIPUR.  
KANPUR. PATNA. THIRUVANANTHAPURAM.